

Station Keys

Updated on: July 2, 2020

NOTE: Station keys should not be shared publicly. Only the Kids' leader or a high level, trusted volunteer should have this.

If you do not know the current station key, please contact the Technology Department to receive it.

What are station keys?

If you need to make quick changes to a station, you can change the settings directly from the station by using a created station key.

Click the settings gear at the bottom right to enter the station key.

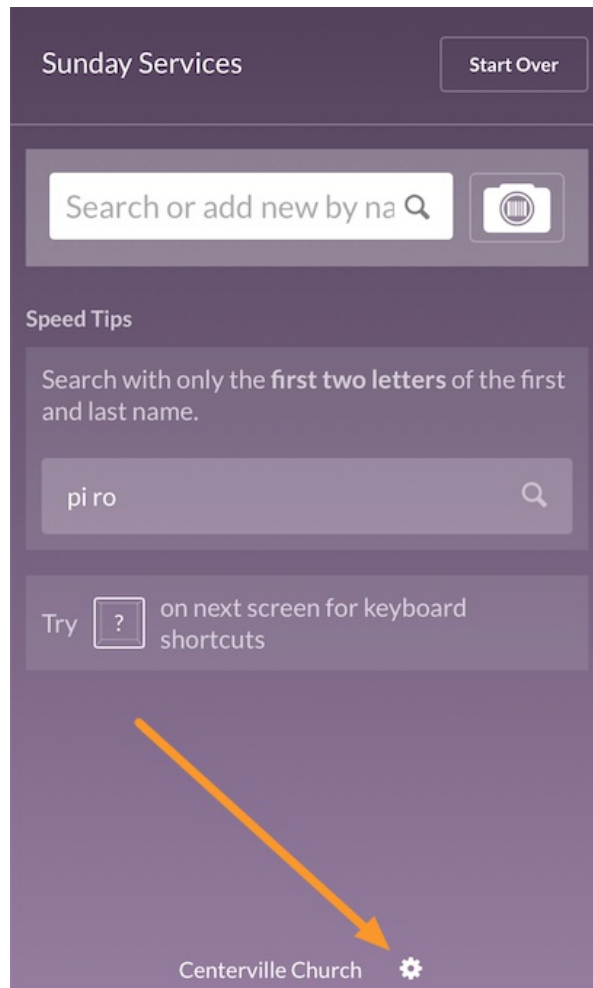

Enter the Station Key and select *Login* to be taken to the [Station Settings](#).

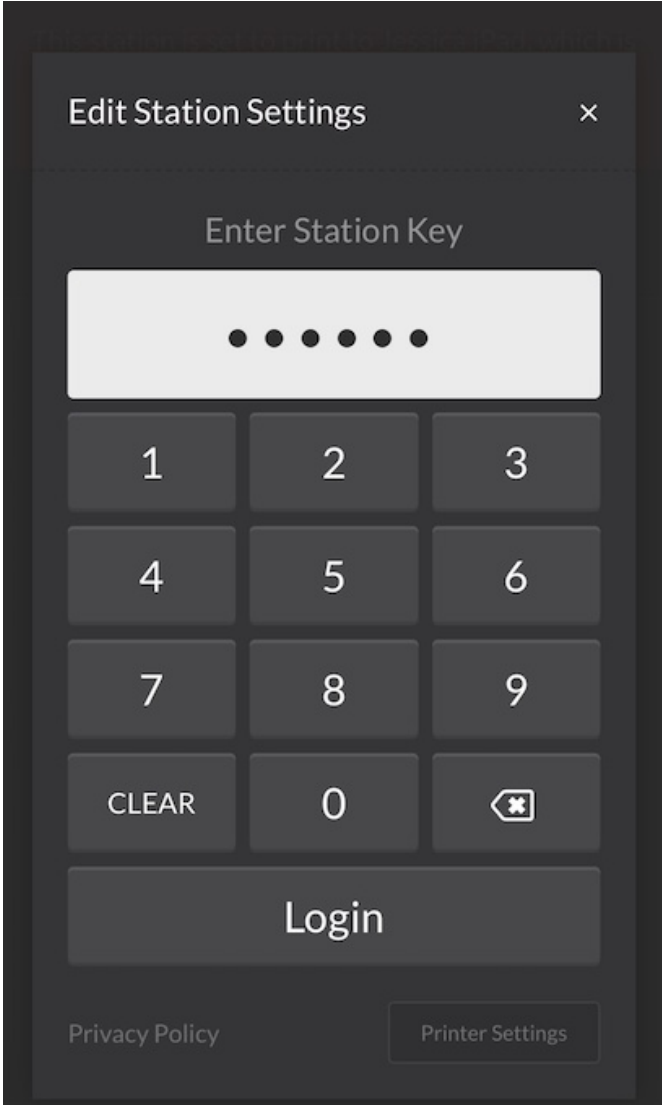

You can then switch the station to a different event, lock it to a specific location, change the theme, etc.

In addition to the Station Settings, you can make changes to the [Printer Settings](#) on mobile devices. You do not need to enter the station key to access the printer settings.